

Ochranný plastový roh, nastaviteľný od 90° do 180°  
Corner protector, with adjustable opening from 90° to 180°

Kód/Code	Materiál Material	MJ/UM	Váha/Weight
208352	polypropylén	kus/piece	0,312 kg

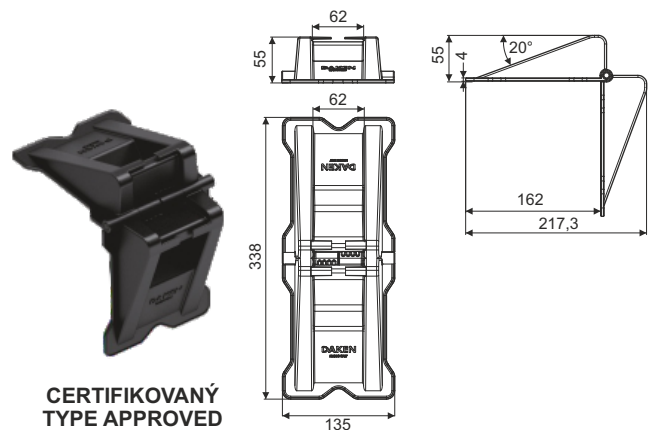

Račňa s 50 mm popruhom, dĺžka 8 m, nosnosť 5000 kg  
Ratchet with 50 mm strap with narrow hooks, length 8 m, load capacity 5000 kg

Kód/Code	Povrchová úprava Surface treat.	MJ/UM	Váha/Weight
561285	pozink./galvanized	kus/piece	2,700 kg

Račňa s 50 mm popruhom, dĺžka 10 m, nosnosť 5000 kg  
Ratchet with 50 mm strap with narrow hooks, length 10 m, load capacity 5000 kg

Kód/Code	Povrchová úprava Surface treat.	MJ/UM	Váha/Weight
561210	pozink./galvanized	kus/piece	2,900 kg

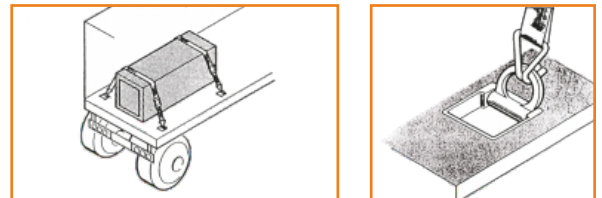

Račňa s 50 mm popruhom so zaist'ovacím háčikmi, dĺžka 4 m, nosnosť 1700 kg  
Ratchet with 50 mm strap with e-track fitting, length 4 m, load capacity 1700 kg

Kód/Code	Povrchová úprava Surface treat.	MJ/UM	Váha/Weight
565102	pozink./galvanized	kus/piece	3,000 kg

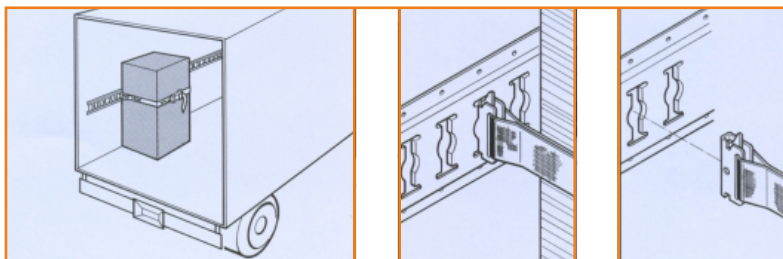

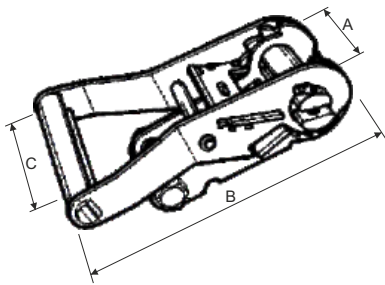

Račňa oceľová pre popruh  
Steel ratchet buckles for strap

Kód Code	Povrch. úprava Surface treat.	MJ UM	A (mm)	B (mm)	C (mm)	Nosnosť Load cap.	Váha Weight
563411	pozink./galv.	kus/piece	50	240	100	5000 kg	1,100 kg

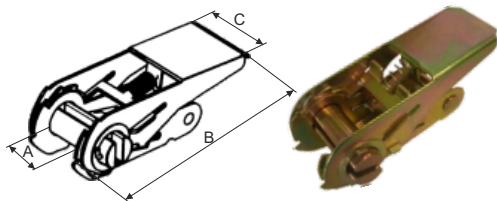

Račňa oceľová pre popruh  
Steel ratchet buckles for strap

Kód Code	Povrch. úprava Surface treat.	MJ UM	A (mm)	B (mm)	C (mm)	Nosnosť Load cap.	Váha Weight
563404	pozink./galv.	kus/piece	25	115	40	800 kg	0,200 kg

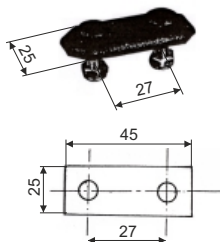
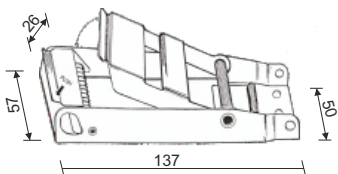

Račňa nerezová, nosnosť 1360 kg  
Stainless steel ratchet buckles, load capacity 1360 kg

Kód/Code	Materiál/Material	MJ/UM	Váha/Weight
563408	nerez/stainless steel	kus/piece	0,320 kg
<b>Plastová podložka Plastic plate</b>			
563409	plast/plastic	kus/piece	0,080 kg
<b>Podložka Plate</b>			
563410	nerez/stainless steel	kus/piece	0,010 kg

Hák oceľový nosnosť do 5000 kg, Ø 12 mm  
Steel hook, max. load capacity 5000 kg, Ø 12 mm

Kód/Code	Povrch. úprava Surface treat.	MJ/UM	A (mm)	B (mm)	C (mm)	D (mm)	Váha/Weight
564921	pozink./galv.	kus/piece	53	60	77	15	0,200 kg

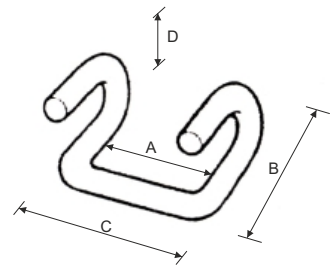

Hák oceľový nosnosť do 1500 kg, Ø 10 mm  
Steel hook, max. load capacity 1500 kg, Ø 10 mm

Kód/Code	Povrch. úprava Surface treat.	MJ/UM	A (mm)	B (mm)	C (mm)	D (mm)	Váha/Weight
564922	pozink./galv.	kus/piece	55	75	37	15	0,145 kg

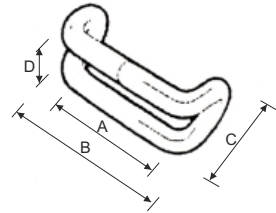

Hák oceľový nosnosť do 1500 kg, hrúbka 3 mm  
Steel hook, max. load capacity 1500 kg, thickness 3 mm

Kód/Code	Povrch. úprava Surface treat.	MJ/UM	A (mm)	B (mm)	C (mm)	D (mm)	Váha/Weight
564940	pozink./galv.	kus/piece	50	39	65	18	0,200kg

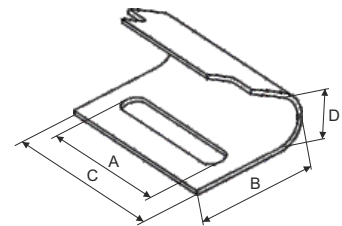

Hák oceľový nosnosť do 300 kg, Ø 7 mm  
Steel hook, max. load capacity 300 kg, Ø 7 mm

Kód/Code	Povrch. úprava Surface treat.	MJ/UM	A (mm)	B (mm)	C (mm)	D (mm)	Váha/Weight
564913	pozink./galv.	kus/piece	25	51	38	10	0,046 kg

